

REV	LTR	DESCRIPTION	DATE	DWN
-----	-----	-------------	------	-----

A  
B  
C  
D  
E

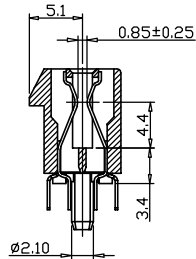

SECTION A-A

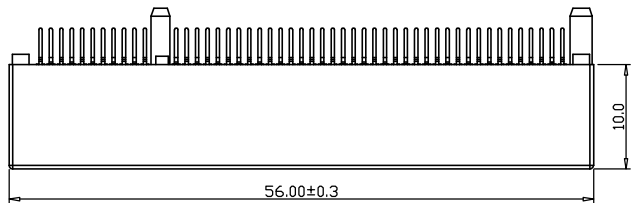
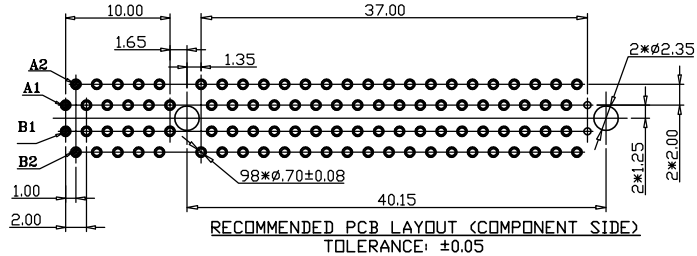

RECOMMENDED PCB LAYOUT (COMPONENT SIDE)  
TOLERANCE: ±0.05

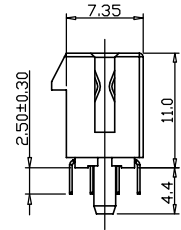
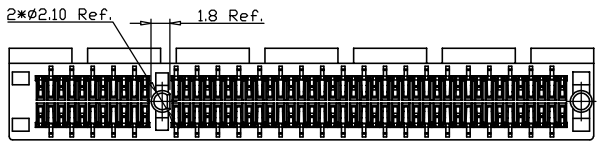
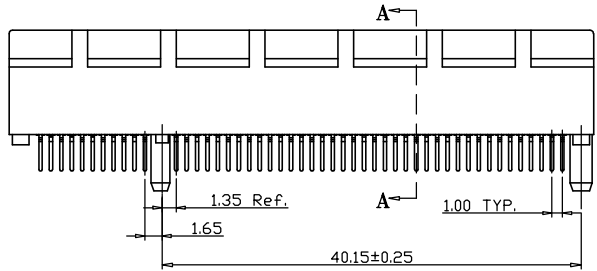
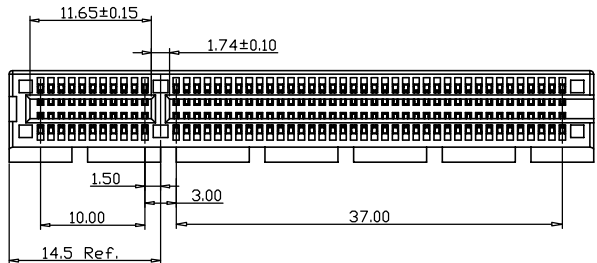

**\*Material:**

- 1.Housing: LCP+30%G/F,UL94 V-0, Color:Black;
- 2.Terminal: Brass,T=0.25mm;
- Plating: Gold in contact area;
- 80u" Min Tin in solder area;
- 30u" MIN.NICKEL UNDERPLATING OVER ALL.

**\*Electrical Characteristics:**

- 1:Contact Resistance: 30mΩ Max.
- 2:Insulation Resistance: 1000MΩ Min.
- 3:Dielectric Strength: 500V DC/1MIN.
- 4.Contact Current rating: 1.1 A Per Pin Min.

**\*Mechanical Characteristics:**

- 1:Insertion Force: 1.15N per contact pair Max.
- 2:Extraction Force: 0.15N per contact pair Min.
- 3.Durability rating: 50 Cycles

**\*ORDER INFORMATION:\***

EAST-098 01 A 22 K1 C X

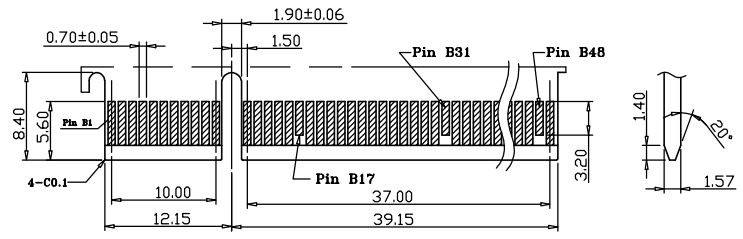
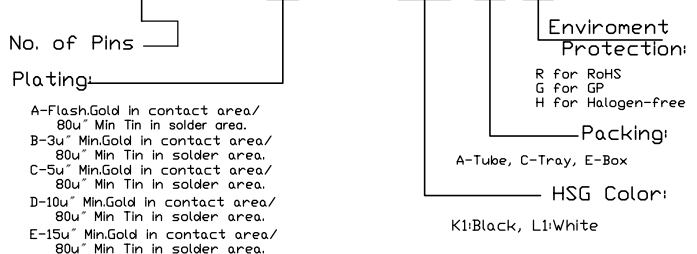

PRIMARY (COMPONENT) SIDE

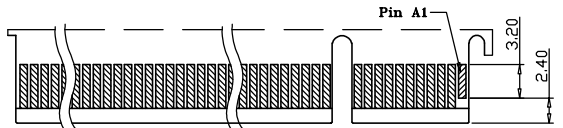

SECONDARY (SOLDER) SIDE

TOLERANCE		深圳市东方御业科技有限公司		TITLE: PCIe 98Pin 开口导柱式DIP型			
LINEAR	ANGLES	Tel:0755-27155560 WWW.DFYCONN.COM		CUSTOMER COPY	PART NO.:	SEE TABLE	
X.±0.50	X°.±2.0°				DWG NO.:	EAST-09801-22	
.X±0.38	.X°±1.0°	APPD:	DRWN: Rocky	UNITS SCALE SHEET REV	MM 1:1 1 OF 1 A/0		
.XX±0.25	.XX°±	CHKD:	DATE: 2018-11-17				
.XXX±0.10	.XXX°±						