

REV.	ECN NO.	MODIFY MATTER	DATE	APPROVED
A		RELEASE TO PRODUCTION		

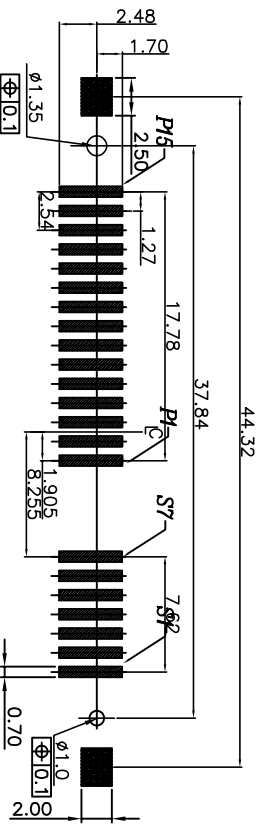

**SPECIFICATION:**  
 1. MATERIAL: LCP E130I 30% G/F UL 94V-0  
 HOUSING: LCP  
 COLOR: BLACK  
 CONTACT: PHOSPHOR BRONZE C5191R-H,T=0.25mm  
 PEG: BRASS C2680R-H,T=0.30mm  
 2. FINISH:  
 CONTACT: 1u"3u"5u"15u" GOLD/TIN PLATING ON CONTACT AREA  
 100u" MIN. TIN PLATING ON SOLDERTAILS  
 50u" MIN. NICKEL UNDERPLATING OVER ALL  
 PEG: 100u" MIN. TIN PLATING ON SOLDERTAILS  
 50u" MIN. NICKEL UNDERPLATING OVER ALL

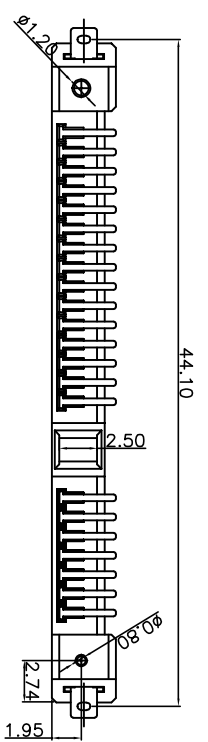
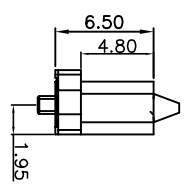
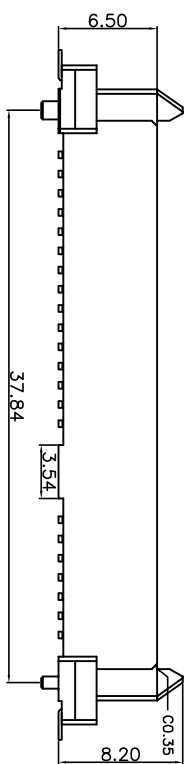
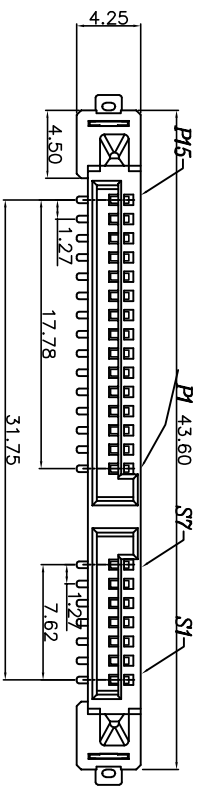

RECOMMENDED PCB LAYOUT  
 PCB TOLERANCE: ±0.05

**EAST-SA18SDS65LDCR**

- 90: 卧式
- 18: 直立
- SD: SMT
- DP: DIP
- P = 公
- S = 母
- 高度
- H: 6.50mm
- P: PBT
- A: PA66
- L: LCP
- 包装
- A- Tube,
- B- Reel,
- C- Tray
- U = 上接触
- D = 下接触

TOLERANCES UNLESS OTHERWISE SPECIFIED:	± 0.38
X X	± 0.25
X XX	± 0.25
X XXX	± 0.20
Angle	± 3°

DRAWN: <b>Qinlx</b>		CHECKED: <b>Chenl</b>		APPROVED: <b>Chenl</b>	
DATE: 2017/09/10		DATE: 2017/09/10		DATE: 2017/09/10	
PART NO: <b>EAST-SA18SDS65LDCR</b>		SCALE: <b>N/A</b>		SHEET: <b>REV.</b>	
DRAWING NO: <b>6.35</b>		SCALE: <b>N/A</b>		SHEET: <b>REV.</b>	

深圳市东方御业科技有限公司  
 WWW.DFYCONN.COM TEL: 0755-27155560

SATA 7+15P 直立式SMT  
 插柱子间距 6.35